

THIS DRAWING IS UNPUBLISHED. RELEASED FOR PUBLICATION  
 © COPYRIGHT 2005 BY TYCO ELECTRONICS CORPORATION. ALL RIGHTS RESERVED.

LOC	DIST	REVISIONS			
P	LTR	DESCRIPTION	DATE	DWN	APVD
AJ	16				
	J	REVISED PER EC 0514-0457-04	04NOV05	TS	JL
	J1	REVISED PER ECO-09-020932	04SEP09	KK	AEG

- ① CONTACT CRIMP TOOLING: CRIMP TOOL M22520/2-01 WITH POSITIONER DMC K997  
 SELECTOR SETTING #6 FOR RG-58/U AND RG-400/U CABLE  
 SELECTOR SETTING #7 FOR RG-142/U AND BELDEN YR20621 CABLE  
 SELECTOR SETTING #4 FOR RG-174/U, RG-188/U & RG-316/U  
 SINGLE AND DOUBLE SHIELDED CABLE.
- ② FERRULE CRIMP TOOLING: CRIMP TOOL M22520/5-01 WITH DIE SET M22520/5-11  
 OR USE A 5.41 [.213] X 10.16 [.400] HEX DIE SET.
- ③ FERRULE CRIMP TOOLING: CRIMP TOOL M22520/5-01 WITH DIE SET M22520/5-35B  
 OR USE A 3.25 [.128] X 10.16 [.400] HEX DIE SET.
- 4. PRODUCT DESIGNED TO MEET PRODUCT SPECIFICATION 108-1574.
- 5. INSTRUCTION SHEET: 408-4032
- ⑥ OBSOLETE PARTS: OBSOLETE CIS STREAMLINING PER  
 D.RENAUD/D.SINISI

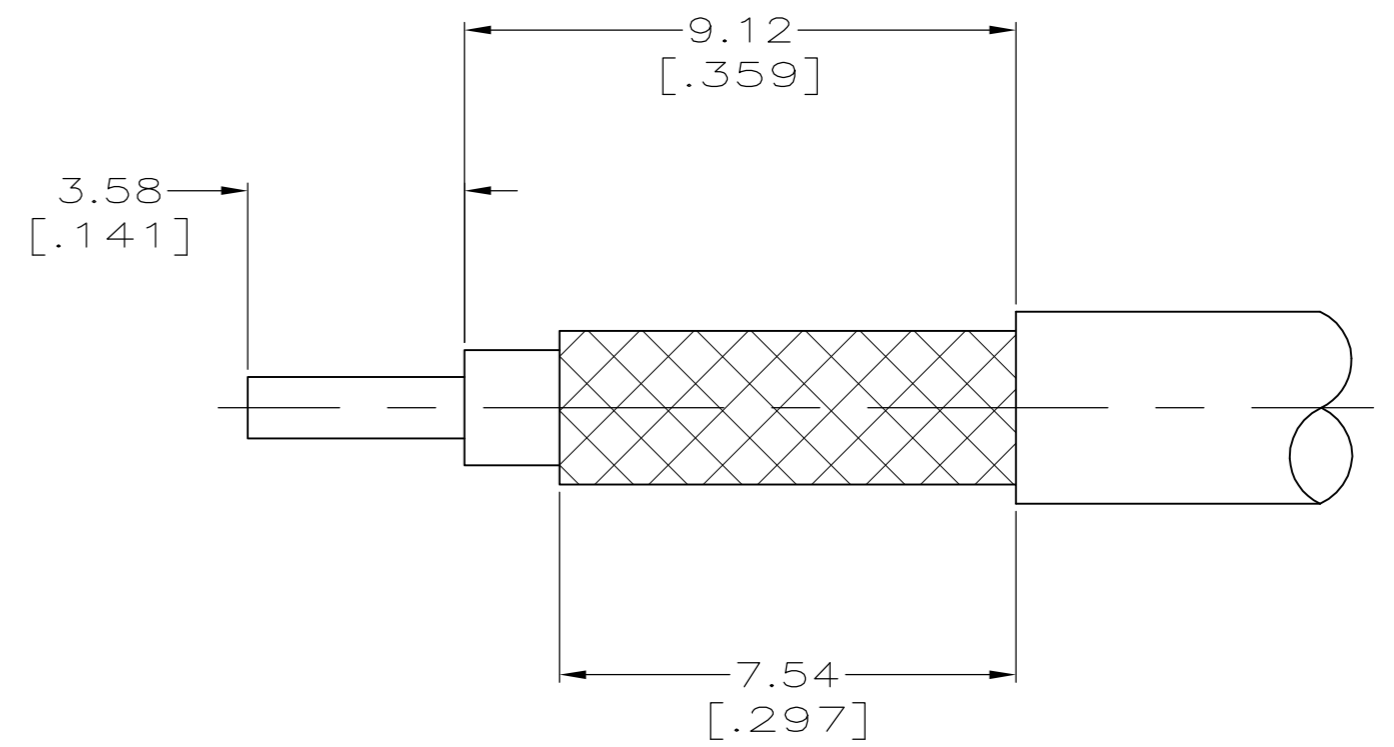
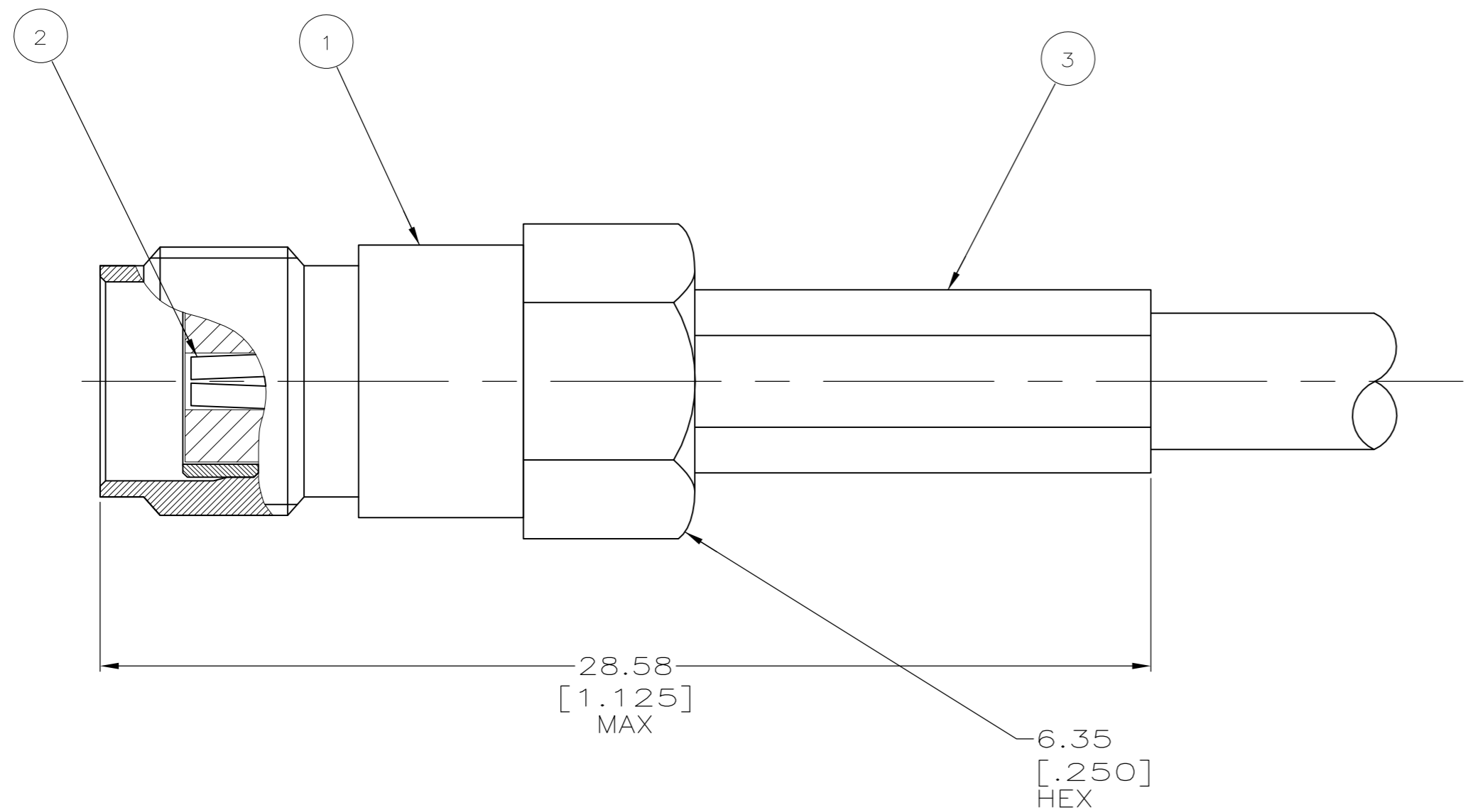

RECOMMENDED STRIP LENGTHS

⑥ OBSOLETE	— ① ③	RG-174, -188, & -316/U	9-446556-1	447842-3	447963-2	9-447648-0
OBSOLETE		RESTRICTED CUSTOMER DRAWING-SEE DASH NUMBER DRAWING				447648-6
OBSOLETE	① ③	BELDEN YR20621	2-446556-7	447961-3	447963-3	447648-5
OBSOLETE	① ③	RG-188 & -316 DOUBLE SHIELDED	2-446556-4	447842-3	447963-2	447648-4
	① ③	RG-174, -188, & -316/U	9-446556-1	447842-3	447963-2	447648-3
OBSOLETE	① ③	RG-142, -142A, -142B, & -400/U	9-446556-0	447961-3	447963-1	447648-2
OBSOLETE	① ③	RG-58, -58A, -58B & -58C/U	9-446556-2	447961-3	447963-1	447648-1
		CRIMP TOOLING	CABLE	③ FERRULE QTY=1	② CONTACT QTY=1	① JACK ASSY QTY=1
						PART NUMBER

THIS DRAWING IS A CONTROLLED DOCUMENT.		DWN B. MOYER 13MAY97	Tyco Electronics Corporation Harrisburg, PA 17105-3608	
DIMENSIONS: mm [INCHES]		CHK J. CABARLO 14MAY97	NAME JACK, HEX CRIMP, COMMERCIAL, SMA	
TOLERANCES UNLESS OTHERWISE SPECIFIED:		APVD J. CABARLO 14MAY97	SIZE A2	
0 PLC ± -		PRODUCT SPEC	CAGE CODE 00779	DRAWING NO C=447648
1 PLC ± -		APPLICATION SPEC	SCALE 8:1	SHEET 1 OF 1
2 PLC ± 0.40 [.016]		WEIGHT	REV J1	
3 PLC ± -		CUSTOMER DRAWING		
4 PLC ± -				
ANGLES ± -				
FINISH				