

Injector/extractor handle type VII

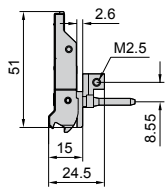

Plastic (telecom)

For inserting and removing connectors with a large number of pins. This handle was specifically designed for use in telecom applications.

- Insertion/removal function
- Optionally with ½ HP offset PCB attachment, e. g. for component mounting on both sides
- Minimum front space requirements, due to foldup handle
- Keyable
- Optional integral micro-switch for "live insertion" applications
- ESD pin to dissipate static charges prior to making contact with the connectors and for precise positioning of the board type plug-in unit
- Large labelling area on the front

Material:

Plastic

Supply includes:

Assembly parts.

Note:

Insertion only when used with front horizontal rails, with 10 mm extension (B, B1, B2), see page 109-110

Handles without offset

Installation	Packs of	Order No.
top	1	3688.784
bottom	1	3688.785

Handles with ½ HP offset

Installation	Packs of	Order No.
top	1	3688.780
bottom	1	3688.781

+ Accessories:

Keys, see page 124
 Keyable guide rails, see page 120
 Keyable guide rails with ½ HP offset, see page 121
 Micro-switches, see page 141
 Connector pin for buying, see page 139

Injector/extractor handle type VII

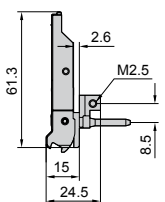

Metal (telecom)

For inserting and removing PCBs with a high connector pin-count (up to 815 N). This handle was specifically designed for use in telecom applications.

- Insertion/removal function
- Optionally with ½ HP offset PCB attachment, e. g. for component mounting on both sides
- Minimum front space requirements due to foldup handle
- Keyable
- Optional integral micro-switch for "live insertion" applications
- ESD pin to dissipate static charges prior to making contact with the connectors and for precise positioning of the board type plug-in unit
- Metal design for use in aggressive atmospheres

Material:

Die-cast zinc

Supply includes:

Assembly parts.

Note:

Insertion only when used with front horizontal rails, with 10 mm extension (B, B1, B2), see page 109-110

Handles without offset

Installation	Packs of	Order No.
top	1	3688.790
bottom	1	3688.791

Handles with ½ HP offset

Installation	Packs of	Order No.
top	1	3688.786
bottom	1	3688.787

+ Accessories:

Keys, see page 124
 Keyable guide rails, see page 120
 Keyable guide rails with ½ HP offset, see page 121
 Micro-switches, see page 141
 Connector pin for buying, see page 139

Micro-switch



For "live insertion" applications. Installation in injector/extractor handles, types IV, IVs and VII. May also be retrofitted.

Technical specifications:

Switching load: 50 mA 30 V DC
 Service life:
 At nominal load: 30.000
 mechanical: 50.000

Packs of	Order No.
10	3684.410

+ Also required:

Micro-switch mounting clip, see page 141